

VISTA® 631 LSO LoPro

DOCUMENTATION WORKSHEET: RETAIN IN PATIENT RECORD

Page 1 of 2

Doctor: _____ Fitter: _____
 Patient Name: _____ Date: _____
 Patient #: _____ Additional Follow-Up Dates: _____
 TOOLS NECESSARY: Scissors • Heat Gun • Tape Measure

FOR USE WITH PRODUCTS MANUFACTURED BY ASPEN MEDICAL PRODUCTS ONLY. THIS PRODUCT IS INTENDED FOR APPLICATION BY HEALTH CARE PRACTITIONERS AS DIRECTED BY A PHYSICIAN OR OTHER QUALIFIED MEDICAL AUTHORITY. THIS IS A PREFABRICATED ORTHOSIS. IT IS INTENDED TO BE CUSTOMIZED TO AN INDIVIDUAL PATIENT. FOLLOW THE STEPS BELOW TO CUSTOMIZE.

STEP 1 - MEASUREMENTS

1 Lower Rib
Circumference = _____

2 Hip
Circumference = _____

3 T9 to
Sacrococcygeal
Junction = _____

TIME SPENT: _____

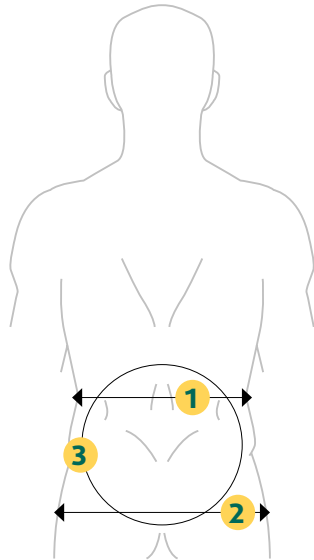

STEP 2 - CUSTOMIZE BACK PANEL TO ANATOMY

- A. Measure patient's lordosis then customize back panel to anatomy.
 B. To customize back panel, remove the panel, heat, trim, and reassemble.

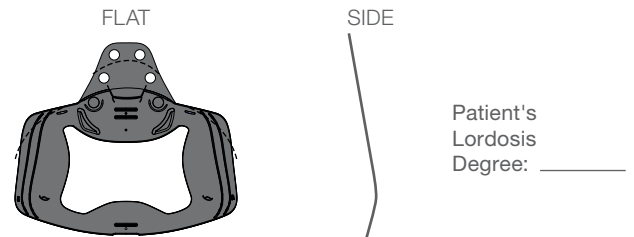

Heat form individual patient's anatomy and contour to create intimate fit for individual's lordosis and soft tissue. Trim for individual patient's anatomy based on 3 _____

- C. Remove lordotic pad to accommodate for lordosis. ☐ YES ☐ NO

TIME SPENT: _____

STEP 3 - CUSTOMIZE SIZING AND TIGHTENING MECHANISM

SIZING IS CRITICAL TO PROPER PERFORMANCE
 Use the measurements below to customize to patient's anatomy.

- A. Use waist circumference (average of 1 and 2 _____) to determine where to fit rivets of belt through proper sizing adjustment holes in sides of back panel.

- B. Once proper size is achieved, pull taut to lock rivets in place.

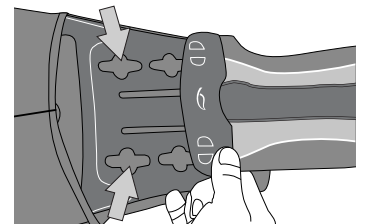

- C. Adjust length of tightening mechanism. For individual patient, it may be necessary to adjust length of closure string. Trim and adjust length of strings.

☐ YES. AMOUNT CUT _____ ☐ NO

- D. If sizing yields extra plastic and if appropriate to individual's anatomy, trim extra plastic for superior customization to patient's individual anatomy.

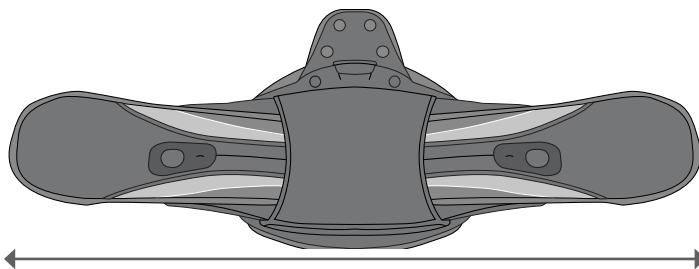
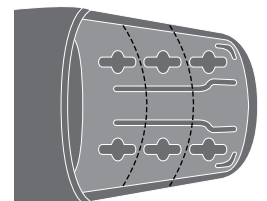

A. _____

TIME SPENT: _____



Aspen Medical Products • Life Changing Innovation • aspenmp.com

6481 Oak Canyon, Irvine, CA 92618 • 800-295-2776 • 949-681-0200 • © 2019 Aspen Medical Products. All rights reserved. Patent Pending.

VISTA® 631 LSO LoPro

DOCUMENTATION WORKSHEET: RETAIN IN PATIENT RECORD

Page 2 of 2

Doctor: _____

Fitter: _____

Patient Name: _____

Date: _____

Patient #: _____

Additional Follow-Up Dates: _____

TOOLS NECESSARY: Scissors • Heat Gun • Tape Measure

STEP 4 - MODIFY RIGID PANELS

MODIFY ANTERIOR PANEL AS NECESSARY

TIME SPENT: _____

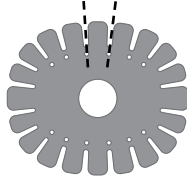

- ☐ Remove and trim to accommodate small and extra small anatomy.
- ☐ Remove and heat mold anterior panel as necessary.

STEP 5 - CUSTOMIZE BELT FIT

ANGLE ANTERIOR PANELS

Every patient has a unique individual anatomy. Determine angulation for proper fit. Circumferential contact at both upper and lower margins of brace is essential for proper brace performance and support.

- A. Bend anterior panel to conform to patient's anatomy.
- B. Angle anterior panels:

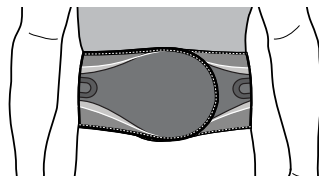

☐ Neutral Configuration for best support

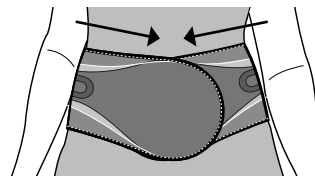

☐ Inferior Angulation Configuration for best support

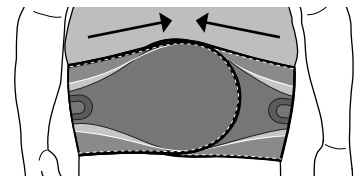

☐ Superior Angulation Configuration for best support

TIME SPENT: _____

STEP 6 - EDUCATION

EDUCATE PATIENTS

Proper education is needed for individual to maintain proper fit throughout total time of wear.

Items to educate patients on:

- ☐ Independent compression mechanics
- ☐ Don and doffing

- ☐ Proper angulation to ensure circumferential contact
- ☐ Proper placement of brace

- ☐ Proper cleaning
- ☐ Follow up appointments

TIME SPENT: _____

CLINICAL JUSTIFICATION FOR CUSTOMIZING BRACE

TOTAL TIME TO CUSTOMIZE BRACE: _____