

## eValve - Instructions

### Installation of the eValve ESSV with a lamination adapter (Art.no - E050202)



- Place the Lamination adapter (PROD0501) with the plastic dummy (PROD0503) directly with the golden flat side onto the PVA foil with self-adhesive tape.
- Pull on the desired number of layers of lamination material over the model. Apply PVA bag and resin.
- When prosthetic socket has cured, remove it from positive model. Grind around the dummy and remove it.



- Install the filter (PROD0502) into the Lamination adapter.
- Screw in the eValve ESSV (COMP0501) with a Torx TX20 into the Lamination adapter, do not push on the Torx TX20.

### Installation of the eValve ESSV with a glue adapter (Art.no - E050203)



- Assemble the glue adapter (PROD0401) with the plastic dummy (PROD0503).
- Drill a Ø 10 mm hole where you want to place the glue adapter in the prosthetic socket wall.
- Carefully heat the prosthetic socket where you have drilled the hole and push the glue adapter from the inside of the socket and out until the glue adapter golden flat side is flush with the inside surface of the prosthetic socket.

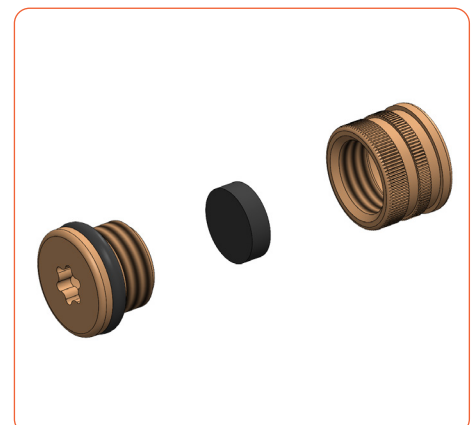

- Use a glue/adhesive that is strong and gives a good and sealed bond between the prosthetic socket and the glue adapter. (Like the +PLU-Series adhesive from Embreis AB.)
- When the adhesive has cured remove the dummy.
- Install the filter (PROD0502) in the Lamination adapter.
- Screw in the eValve ESSV (COMP0501) with a Torx TX20 into the Lamination adapter, do not push on the Torx TX20.